

X-SERIES WASHERS

DIMENSIONS



NLX6sp-NLX20
Ø, ±0.2 mm

NLX6sp-NLX20
Ø, ±0.2 mm

NLX6sp-NLX16sp
T +0.0/-0.4 mm

NLX3/4"-NLX20
T +0.0/-0.5 mm

Bolt size Metric UNC	Part Number	Ø _i [mm]	Ø _o [mm]	Thickness T [mm]	Approx. weight kg/100 pairs	Min. Package [pairs]
M6	9006				0.07	200
M6	9066				0.16	200
M8	5/16" 9008				0.14	200
M8	5/16" 9088				0.25	200
	3/8" 9009				0.26	200
M10	9010				0.27	200
M10	9110				0.62	200
M12	9012				0.43	200
	1/2" 9013				0.42	200
M14	9/16" 9014				0.70	100
M16	5/8" 9016				0.98	100
M16	5/8" 9116				1.78	100
	3/4" 9019				1.76	100
M20	9020				1.70	100

*CONTACT MAYURA
BUMI ENGINEERING
FOR THE DETAILS*

In order to assure the unique mechanical locking function of Nord-Lock X-Series washers, the hardness of the mating surfaces must be lower than the hardness of the Nord-Lock XSeries washers.

Material standard	Hardening	Coating	Corrosion resistance	Temperature range
Steel EN 1.7225	Through hardened	Base coat: Delta Protekt® KL100 zinc flake coating Top coat: VH 302 GZ	Minimum 1,000 hours in salt spray test (according to ISO 9227)	-40°C to 150°C

WHEEL NUTS

DIMENSIONS

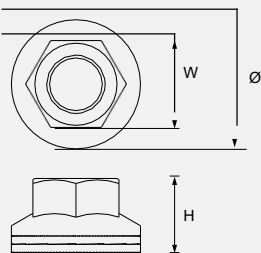

Thread	Part Number	Width W [mm]	Ø [mm]	Height H [mm]	Tightening torque Metric [Nm] UNC [ftlb]	Clamp load Metric [kN] UNC [lb]
M16x1.5	MWN -16					~100 ~22,500
M18x1.5	MWN-18					~130 ~29,200
M20x1.5	MWN-20					~160 ~36,000
M22x1.5	MWN-22					~180 ~40,500
7/8"-11 BSF	MWN-23					~170 ~38,200
M24x1.5	MWN-24					~240 ~54,000

*CONTACT MAYURA BUMI
ENGINEERING FOR THE DETAILS*

Coating	Corrosion resistance	Lubrication	Property class
Base coat: Delta Protekt® KL100 zinc flake coating Top coat: VH 302 GZ	Minimum 600 hours in salt spray test (according to ISO 9227)	Anti-corrosive wax Dry film lubricant/ lubricating paste	Class 10