

NORD-LOCK ORIGINAL WASHERS

PRODUCT SELECTION

Nord-Lock offers products in a wide range of sizes, shapes and materials. They are developed to suit even the toughest environments. If you need support selecting the most appropriate product, please contact your closest Nord-Lock sales representative.

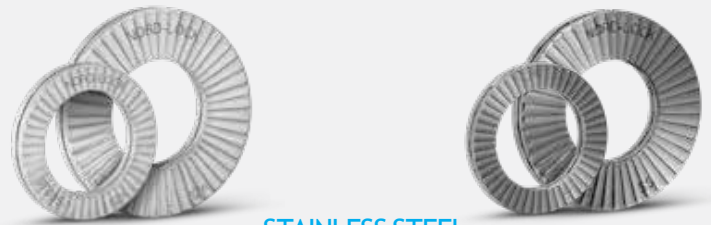

STEEL

STAINLESS STEEL

* Washer hardness must be greater than the hardness of the mating surfaces in order to assure its mechanical function.

** Corrosion resistance is known as PREN. PREN, or Pitting Resistance Equivalent Number, is a theoretical number calculated from the chemical composition of the raw material. The formula is: $PREN = \%Cr + 3.3x\%Mo + 16x\%N$.

*** Temperature recommendations are based on information from the raw material supplier and testing. The locking function is not affected within the specified range.

Applications	General steel application	General stainless steel application
Material Standard	EN 1.7182	EN 1.4404
Hardening	Through hardened	Surface hardened
Hardness*	≥ 465HV1	≥ 520HV0.05
Corrosion Resistance**	Minimum 1,000 hours in salt spray test according to ISO 9227	PREN 27
Temperature Range***	-50°C to 200°C	-160°C to 500°C
Bolt Grades	Up to 12.9	Up to A4-80
Product Designation	NL NLsp	NLss NLspss
Laser Marking Type Code	flZn	SS
Size Range	M3–M130 #5 to 5"	M3–M80 #5 to 3 1/8"
Coating	Base coat: Delta Protekt® KL100 zinc flake coating Top coat: VH 302 GZ	—



254 SMO®

ALLOY C-276

ALLOY 718

Applications	Corrosive environment – chloride rich environments, pumps, heat exchangers, nuclear, food, medical, processing	Acidic environment – chemical industry, evaporators, offshore, downhole tooling	High temperatures – gas turbines, turbo charges, incinerators
Material Standard	EN 1.4547	EN 2.4819 or equivalent	EN 2.4668 or equivalent
Hardening	Surface hardened	Surface hardened	Surface hardened
Hardness*	≥ 600HV0.05	≥ 520HV0.05	≥ 620HV0.05
Corrosion Resistance**	PREN 45	PREN 68	PREN 29
Temperature Range***	-160°C to 500°C	-160°C to 500°C	-160°C to 700°C
Bolt Grades	Up to A4-80	—	—
Product Designation	NLss-254 NLspss-254	NLss-276 NLspss-276	NLss-718 NLspss-718
Laser Marking Type Code	254	276	718
Size Range	M3–M39 #5 to 1 1/2"	M4–M20 #5 to 1 1/2"	M4–M20 #5 to 1 1/2"
Coating	—	—	—

STEEL ORIGINAL WASHERS

DIMENSIONS

Delta Protekt® Zinc Flake Coating

Through hardened EN 1.7182

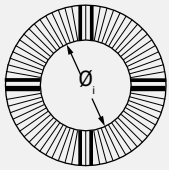

NL3–NL8sp
Ø_i ±0.1 mm
NL3/8"–NL42
Ø_i ±0.2 mm
NL45–NL130
Ø_i +0.5 / -0.0 mm

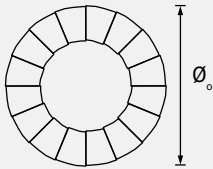

NL3–NL1"sp
Ø_i ±0.2 mm
NL27–NL42
Ø_i ±0.3 mm
NL45–NL130
Ø_i +0.0 / -2.0 mm

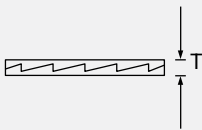

NL3–NL42
T ±0.25 mm
NL45–NL130
T ±0.75 mm

Note that washers with thickness 6.6 mm have a thickness tolerance +0.0 / -0.5 mm

Nord-Lock steel washers in sizes NL3–NL52 with zinc flake coating are standard stock items.

Torque guidelines



2D/3D CAD models



- Torque guidelines:
Web app: torquelator.nord-lock.com
www.nord-lock.com/torque

- 2D/3D CAD models:
www.nord-lock.com/cad

Bolt size	Part Number	Ø _i	Ø _e	Thickness T	Approx. weight	Min. Package	
Metric	UNC	[mm]	[mm]	[mm]	kg/100 pairs	[pairs]	
M3	#5	5003	3.4	7.0	1.8	0.03	200
M3.5	#6	5035	3.9	7.6	1.8	0.04	200
M3.5	#6	5135	3.9	9.0	1.8	0.06	200
M4	#8	5004	4.4	7.6	1.8	0.04	200
M4	#8	5044	4.4	9.0	1.8	0.06	200
M5	#10	5005	5.4	9.0	1.8	0.05	200
M5	#10	5055	5.4	10.8	1.8	0.11	200
M6		5006	6.5	10.8	1.8	0.07	200
M6		5066	6.5	13.5	2.5	0.20	200
	1/4"	5007	7.2	11.5	2.5	0.08	200
	1/4"	5077	7.2	13.5	2.5	0.18	200
M8	5/16"	5008	8.7	13.5	2.5	0.15	200
M8	5/16"	5088	8.7	16.6	2.5	0.28	200
	3/8"	5009	10.3	16.6	2.5	0.23	200
	3/8"	5099	10.3	21.0	2.5	0.48	200
M10		5010	10.7	16.6	2.5	0.22	200
M10		5110	10.7	21.0	2.5	0.47	200
M11	7/16"	5011	11.4	18.5	2.5	0.29	200
M12		5012	13.0	19.5	2.5	0.29	200
M12		5112	13.0	25.4	3.4	0.93	100
	1/2"	5013	13.5	19.5	2.5	0.27	200
	1/2"	5113	13.5	25.4	3.4	0.90	100
M14	9/16"	5014	15.2	23.0	3.4	0.56	100
M14	9/16"	5114	15.2	30.7	3.4	1.41	100
M16	5/8"	5016	17.0	25.4	3.4	0.67	100
M16	5/8"	5116	17.0	30.7	3.4	1.28	100
M18		5018	19.5	29.0	3.4	0.89	100
M18		5118	19.5	34.5	3.4	1.58	100
	3/4"	5019	20.0	30.7	3.4	1.05	100
	3/4"	5119	20.0	39.0	3.4	2.21	100
M20		5020	21.4	30.7	3.4	0.93	100
M20		5120	21.4	39.0	3.4	2.09	100
M22	7/8"	5022	23.4	34.5	3.4	1.25	100
M22	7/8"	5122	23.4	42.0	4.6	3.19	50
M24		5024	25.3	39.0	3.4	1.74	100
M24		5124	25.3	48.5	4.6	4.51	50
	1"	5025	27.9	39.0	3.4	1.53	100
	1"	5125	27.9	48.5	4.6	4.20	50
M27		5027	28.4	42.0	5.8	3.14	50
M27		5127	28.4	48.5	5.8	5.27	25
M30	1 1/8"	5030	31.4	47.0	5.8	4.10	50
M30	1 1/8"	5130	31.4	55.0	5.8	7.00	25
M33	1 1/4"	5033	34.4	48.5	5.8	3.89	25
M33	1 1/4"	5133	34.4	58.5	5.8	8.00	25
M36	1 3/8"	5036	37.4	55.0	5.8	5.49	25
M36	1 3/8"	5136	37.4	63.0	6.6	9.15	25
M39	1 1/2"	5039	40.4	58.5	5.8	5.89	25
M42		5042	43.2	63.0	5.8	7.97	25
M45	1 3/4"	5045	46.2	70.0	7.0	10.20	25
M48		5048	49.6	75.0	7.0	12.00	25
M52	2"	5052	53.6	80.0	7.0	13.00	25
M56	2 1/4"	5056	59.1	85.0	7.0	13.50	10
M60		5060	63.1	90.0	7.0	15.20	10
M64	2 1/2"	5064	67.1	95.0	7.0	16.70	10
M68		5068	71.1	100.0	9.5	28.20	1
M72		5072	75.1	105.0	9.5	30.70	1
M76	3"	5076	79.1	110.0	9.5	33.30	1
M80	3 1/8"	5080	83.1	115.0	9.5	36.00	1
M85		5085	88.1	120.0	9.5	37.80	1
M90		5090	92.4	130.0	9.5	47.70	1
M95		5095	97.4	135.0	9.5	49.80	1
M100	4"	5100	103.4	145.0	9.5	58.90	1
M105		5105	108.4	150.0	9.5	61.30	1
M110		5110	113.4	155.0	9.5	63.50	1
M115		5115	118.4	165.0	9.5	75.30	1
M120		5120	123.4	170.0	9.5	77.90	1
M125		5125	128.4	173.0	9.5	76.60	1
M130	5"	5130	133.4	178.0	9.5	79.20	1

STAINLESS STEEL ORIGINAL WASHERS

DIMENSIONS

Surface hardened EN 1.4404
(AISI 316L)

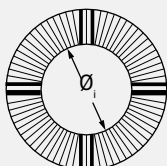

NL3ss-NL8spss
Ø_i ±0.1 mm
NL3/8"ss-NL42ss
Ø_i ±0.2 mm
NL45ss-NL80ss
Ø_i +0.5 / -0.0 mm

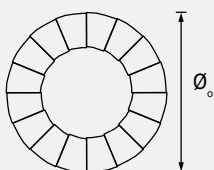

NL3ss-NL1"spss
Ø_o ±0.2 mm
NL27ss-NL42ss
Ø_o ±0.3 mm
NL45 ss-NL80ss
Ø_o +0.0 / -2.0 mm

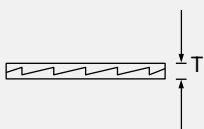

NL3ss-NL1"spss
T ±0.25 mm
NL27ss-NL42ss
T +0.0 / -0.5 mm
NL45ss-NL80ss
T ±0.75 mm

EN 1.4404 is an austenitic chromium-nickel stainless steel containing molybdenum. EN 1.4404 is one of the most commonly used stainless steel grades. This stainless steel also has extra-low carbon content in order to reduce the risk of chromium-carbide precipitation.

Nord-Lock washers made of EN 1.4404 are suitable for most applications where no chlorides or acids are present.

Nord-Lock washers made of stainless steel are standard stock items, yet subject to prior sale.

- Torque guidelines:

Web app: torquelator.nordlock.com
www.nord-lock.com/torque

- 2D/3D CAD models:

www.nord-lock.com/cad

Bolt size	Part Number	Ø _i	Ø _o	Thickness T	Approx. weight	Min. Package	
Metric	UNC	[mm]	[mm]	[mm]	kg/100 pairs	[pairs]	
M3	#5	6003	3.4	7.0	2.2	0.04	200
M3.5	#6	6035	3.9	7.6	2.2	0.04	200
M3.5	#6	6135	3.9	9.0	2.2	0.07	200
M4	#8	6004	4.4	7.6	2.2	0.04	200
M4	#8	6044	4.4	9.0	2.2	0.07	200
M5	#10	6005	5.4	9.0	2.2	0.06	200
M5	#10	6055	5.4	10.8	2.2	0.11	200
M6		6006	6.5	10.8	2.2	0.09	200
M6		6066	6.5	13.5	2.0	0.16	200
	1/4"	6007	7.2	11.5	2.2	0.09	200
	1/4"	6077	7.2	13.5	2.2	0.15	200
M8	5/16"	6008	8.7	13.5	2.0	0.12	200
M8	5/16"	6088	8.7	16.6	2.0	0.23	200
	3/8"	6009	10.3	16.6	2.0	0.19	200
	3/8"	6099	10.3	21.0	2.0	0.38	200
M10		6010	10.7	16.6	2.0	0.18	200
M10		6110	10.7	21.0	2.0	0.37	200
M11	7/16"	6011	11.4	18.5	2.2	0.26	200
M12		6012	13.0	19.5	2.0	0.23	200
M12		6112	13.0	25.4	3.0	0.82	100
	1/2"	6013	13.5	19.5	2.0	0.22	200
	1/2"	6113	13.5	25.4	3.2	0.80	100
M14	9/16"	6014	15.2	23.0	3.0	0.49	100
M14	9/16"	6114	15.2	30.7	3.2	1.31	100
M16	5/8"	6016	17.0	25.4	3.0	0.59	100
M16	5/8"	6116	17.0	30.7	3.2	1.13	100
M18		6018	19.5	29.0	3.2	0.80	100
M18		6118	19.5	34.5	3.2	1.56	100
	3/4"	6019	20.0	30.7	3.2	0.96	100
	3/4"	6119	20.0	39.0	3.2	2.10	100
M20		6020	21.4	30.7	3.0	0.82	100
M20		6120	21.4	39.0	3.2	2.06	100
M22	7/8"	6022	23.4	34.5	3.2	1.23	100
M22	7/8"	6122	23.4	42.0	3.2	2.22	50
M24		6024	25.3	39.0	3.2	1.59	100
M24		6124	25.3	48.5	4.5	4.47	50
	1"	6025	27.9	39.0	3.2	1.42	100
	1"	6125	27.9	48.5	3.2	2.79	50
M27		6027	28.4	42.0	6.8	3.45	50
M27		6127	28.4	48.5	6.8	5.34	25
M30	1 1/8"	6030	31.4	47.0	6.8	4.49	50
M30	1 1/8"	6130	31.4	58.5	6.8	9.18	25
M33	1 1/4"	6033	34.4	48.5	6.8	4.28	25
M36	1 3/8"	6036	37.4	55.0	6.8	5.96	25
M39	1 1/2"	6039	40.4	58.5	6.8	6.74	25
M42		6042	43.2	63.0	6.8	7.50	25
M45	1 3/4"	6045	46.2	70.0	6.8	10.20	25
M48		6048	49.6	75.0	6.8	12.00	25
M52	2"	6052	53.6	80.0	9.0	18.04	1
M56	2 1/4"	6056	59.1	85.0	9.0	21.30	1
M60		6060	63.1	90.0	9.0	23.50	1
M64	2 1/2"	6064	67.1	95.0	9.0	25.80	1
M68		6068	71.1	100.0	9.0	28.20	1
M72		6072	75.1	105.0	9.0	30.70	1
M76	3"	6076	79.1	110.0	9.0	33.30	1
M80	3 1/8"	6080	83.1	115.0	9.0	36.00	1

254 SMO® ORIGINAL WASHERS

DIMENSIONS

Surface hardened EN 1.4547

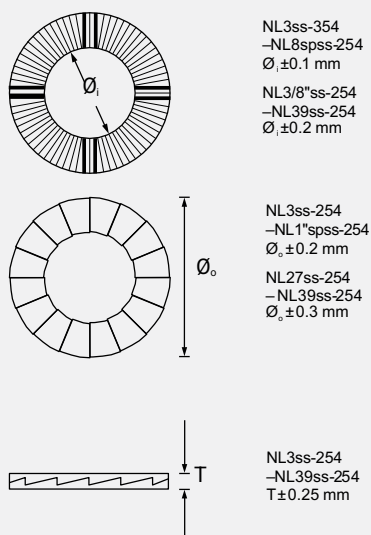

254 SMO® is an austenitic stainless steel designed for maximum resistance to pitting and crevice corrosion. With high levels of chromium, molybdenum, and nitrogen, washers made from 254 SMO® are especially suited for:

- High chloride environments
- Salt water solutions/atmospheres
- Environments where stainless steel washers made of 1.4404 are not adequate

Nord-Lock washers made of 254 SMO® quality are standard stock items, yet subject to prior sale.

- Torque guidelines:
Web app: torquelator.nordlock.com
www.nord-lock.com/torque

- 2D/3D CAD models:
www.nord-lock.com/cad

Bolt size Metric	UNC	PART Number	\varnothing_1 [mm]	\varnothing_2 [mm]	Thickness T [mm]	Approx. weight kg/100 pairs	Min. Package [pairs]
M3	#5	7003	3.4	7.0	2.2	0.04	200
M3.5	#6	7035	3.9	7.6	2.2	0.04	200
M3.5	#6	7135	3.9	9.0	2.2	0.07	200
M4	#8	7004	4.4	7.6	2.2	0.04	200
M4	#8	7044	4.4	9.0	2.2	0.07	200
M5	#10	7005	5.4	9.0	2.2	0.06	200
M5	#10	7055	5.4	10.8	2.2	0.11	200
M6		7006	6.5	10.8	2.2	0.09	200
M6		7066	6.5	13.5	2.0	0.16	200
	1/4"	7007	7.2	11.5	2.2	0.09	200
	1/4"	7077	7.2	13.5	2.2	0.15	200
M8	5/16"	7008	8.7	13.5	2.0	0.12	200
M8	5/16"	7088	8.7	16.6	2.2	0.22	200
	3/8"	7009	10.3	16.6	2.0	0.19	200
	3/8"	7099	10.3	21.0	2.2	0.38	200
M10		7010	10.7	16.6	2.0	0.18	200
M10		7110	10.7	21.0	2.2	0.37	200
M11	7/16"	7011	11.4	18.5	2.2	0.26	200
M12		7012	13.0	19.5	2.0	0.23	200
M12		7112	13.0	25.4	3.2	0.83	100
	1/2"	7013	13.5	19.5	2.0	0.23	200
	1/2"	7113	13.5	25.4	3.2	0.80	100
M14	9/16"	7014	15.2	23.0	3.0	0.49	100
M14	9/16"	7114	15.2	30.7	3.2	1.13	100
M16	5/8"	7016	17.0	25.4	3.0	0.59	100
M16	5/8"	7116	17.0	30.7	3.2	1.13	100
M18		7018	19.5	29.0	3.2	0.80	100
M18		7118	19.5	34.5	3.2	1.56	100
	3/4"	7019	20.0	30.7	3.2	0.96	100
	3/4"	7119	20.0	39.0	3.2	2.14	100
M20		7020	21.4	30.7	3.0	0.83	100
M20		7120	21.4	39.0	3.2	1.98	100
M22	7/8"	7022	23.4	34.5	3.2	1.19	100
M22	7/8"	7122	23.4	42.0	3.2	2.44	50
M24		7024	25.3	39.0	3.2	1.65	100
M24		7124	25.3	48.5	4.5	4.47	50
	1"	7025	27.9	39.0	3.2	1.42	100
	1"	7125	27.9	48.5	5.6	5.30	50
M27		7027	28.4	42.0	5.8	3.10	50
M27		7127	28.4	48.5	5.8	5.34	25
M30	1 1/8"	7030	31.4	47.0	5.8	4.04	50
M33	1 1/4"	7033	34.4	48.5	5.8	3.86	25
M36	1 3/8"	7036	37.4	55.0	5.8	5.50	25
M39	1 1/2"	7039	40.4	58.5	5.8	6.74	25

ALLOY C-276

ORIGINAL WASHERS

DIMENSIONS

Surface hardened EN 2.4819
or equivalent

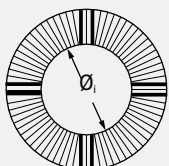

NL4ss-276
-NL8spss-276
Ø ±0.1 mm

NL10ss-276
-NL20ss-276
Ø ±0.2 mm

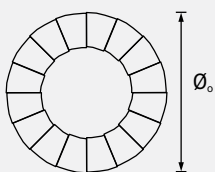

NL4ss-276
-NL20ss-276
Ø ±0.2 mm

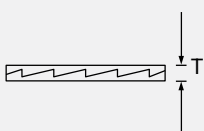

NL4ss-276
-NL12ss-276
T ±0.4 mm

NL12spss-276
-NL20ss-276
T ±0.5 mm

Bolt size	Part	Ø ₁	Ø ₀	Thickness T	Approx. weight	Min. Package	
Metric	UNC	Number	[mm]	[mm]	kg/100 pairs	[pairs]	
M4	#8	8004	4.4	7.6	2.3	0.043	200
M5	#10	8005	5.4	9.0	2.3	0.059	200
M6		8006	6.5	10.8	2.3	0.085	200
M8	5/16"	8008	8.7	13.5	2.3	0.116	200
M8	5/16"	8088	8.7	16.6	2.3	0.220	200
M10		8010	10.7	16.6	2.3	0.175	200
M10		8110	10.7	21.0	2.3	0.372	200
M12		8012	13.0	19.5	2.3	0.230	200
M12		8112	13.0	25.4	3.0	0.820	100
M16	5/8"	8016	17.0	25.4	3.0	0.695	100
M20		8020	21.4	30.7	3.0	0.820	100

Washers made from Alloy C-276 are extremely corrosion resistant and are perfect for use in situations that demand protection from aggressive corrosion and localized corrosion attack. Therefore they are very suitable for use in chemical plants. Important features of this washer include its resistance to oxidizers such as:

- Ferric and cupric chlorides
- Organic and inorganic hot contaminated media
- Chlorine (wet chlorine gas)
- Seawater
- Acids
- Hypochlorite
- Chlorine dioxide

ALLOY 718

ORIGINAL WASHERS

DIMENSIONS

Surface hardened EN 2.4668
or equivalent

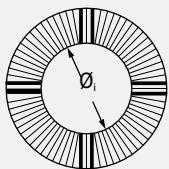

NL4ss-718
-NL8spss-718
Ø₁ +/-0.1 mm

NL12spss-718
-NL20ss-718
Ø₀ +/-0.2 mm

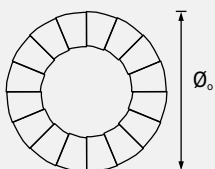

NL4ss-718
-NL20ss-718
Ø₀ +/-0.2 mm

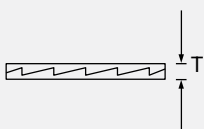

NL4ss-718
-NL12ss-718
(+ NL1/2"ss)
T +/-0.4 mm

NL12spss-718
-NL20ss-718
T +/-0.5 mm

Bolt size	Product	Ø ₁	Ø ₀	Thickness T	Approx. weight	Min. Package	
Metric	UNC	designation	[mm]	[mm]	kg/100 pairs	[pairs]	
M4	#8	3004	4.4	7.6	2.3	0.043	200
M5	#10	3005	5.4	9.0	2.3	0.059	200
M6		3006	6.5	10.8	2.3	0.085	200
	1/4"	3007	7.2	11.5	2.3	0.092	200
M8	5/16"	3008	8.7	13.5	2.3	0.120	200
M8	5/16"	3088	8.7	16.6	2.3	0.220	200
	3/8"	3009	10.3	16.6	2.3	0.190	200
M10		3010	10.7	16.6	2.3	0.175	200
M10		3110	10.7	21.0	2.3	0.372	200
M12		3012	13.0	19.5	2.3	0.230	200
M12		3112	13.0	25.4	3.2	0.820	100
	1/2"	3013	13.5	19.5	2.3	0.238	200
M16	5/8"	3016	17.0	25.4	3.2	0.679	100
	3/4"	3019	20.0	30.7	3.2	0.956	100
M20		3020	21.4	30.7	3.2	0.820	100

Washers made from Alloy 718 have exceptional high yield, tensile and creep-rupture properties at elevated temperatures, as well as corrosion resistance. Therefore these washers are the best choice for high temperature applications including:

- Jet engines
- Gas turbines
- Nuclear reactors
- Pumps

X-SERIES WASHERS

DIMENSIONS

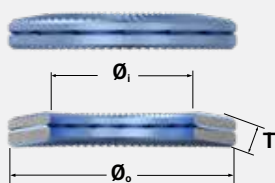

NLX6sp-NLX20
Ø ±0.2 mm

NLX6sp-NLX20
Ø_i ±0.2 mm

NLX6sp-NLX16sp
T +0.0/-0.4 mm

NLX3/4"-NLX20
T +0.0/-0.5 mm

Bolt size	Part	Ø _i	Ø _o	Thickness T	Approx. weight	Min. Package	
Metric	Number	[mm]	[mm]	[mm]	kg/100 pairs	[pairs]	
M6	9006	6.3	10.8	1.80	0.07	200	
M6	9066	6.3	13.5	2.20	0.16	200	
M8	5/16"	9008	8.4	13.5	2.30	0.14	200
M8	5/16"	9088	8.4	16.6	2.30	0.25	200
	3/8"	9009	10.0	16.6	2.70	0.26	200
M10	9010	10.5	16.6	3.00	0.27	200	
M10	9110	10.5	21.0	3.50	0.62	200	
M12	9012	12.5	19.5	3.50	0.43	200	
M12	9112	12.5	25.4	4.20	1.13	100	
	1/2"	9013	13.2	19.5	3.60	0.42	200
M14	9/16"	9014	14.6	23.0	4.10	0.70	100
M16	5/8"	9016	16.6	25.4	4.80	0.98	100
M16	5/8"	9116	16.6	30.7	4.80	1.78	100
	3/4"	9019	19.8	30.7	5.70	1.76	100
M20	9020	20.7	30.7	6.10	1.70	100	

In order to assure the unique mechanical locking function of Nord-Lock X-Series washers, the hardness of the mating surfaces must be lower than the hardness of the Nord-Lock X-Series washers.

Material standard	Hardening	Coating	Corrosion resistance	Temperature range
Steel EN 1.7225	Through hardened	Base coat: Delta Protekt® KL100 zinc flake coating Top coat: VH 302 GZ	Minimum 1,000 hours in salt spray test (according to ISO 9227)	-40°C to 150°C

WHEEL NUTS

DIMENSIONS

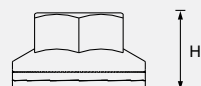
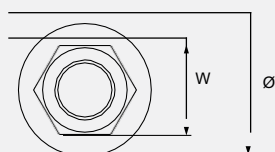

Thread	Part Number	Width W [mm]	Ø [mm]	Height H [mm]	Tightening torque Metric [Nm]	UNC [ftlb]	Clamp load Metric [kN]	UNC [lb]
M16x1.5	MWN -16	24.0	34.5	23.0	280	205	~100	~22,500
M18x1.5	MWN-18	27.0	40.0	24.0	400	295	~130	~29,200
M20x1.5	MWN-20	30.0	45.0	26.0	550	405	~160	~36,000
M22x1.5	MWN-22	32.0	46.0	27.0	650	480	~180	~40,500
7/8"-11 BSF	MWN-23	32.0	46.0	27.0	650	480	~170	~38,200
M24x1.5	MWN-24	36.0	48.0	33.0	950	700	~240	~54,000

Coating	Corrosion resistance	Lubrication	Property class
Base coat: Delta Protekt® KL100 zinc flake coating Top coat: VH 302 GZ	Minimum 600 hours in salt spray test (according to ISO 9227)	Anti-corrosive wax Dry film lubricant/ lubricating paste	Class 10

SC-WASHERS

DIMENSIONS

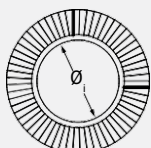

NL12SC–NL16SC
 $\text{Ø} +0.17/-0.1 \text{ mm}$
 NL20SC–NL36SC
 $\text{Ø} \pm 0.2 \text{ mm}$

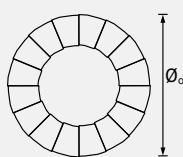

NL12SC–
~~NL16SC~~ $\text{Ø} \pm 0.2 \text{ mm}$
 NL20SC–
~~NL24SC~~ $\text{Ø} \pm 0.3 \text{ mm}$
 NL27SC
 $\text{Ø} \pm 0.5 \text{ mm}$
 NL30SC–NL36SC
 $\text{Ø} \pm 0.6 \text{ mm}$

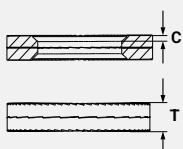

NL12SC–NL30SC
 $T \pm 0.25 \text{ mm}$
 NL36SC
 $T \pm 0.6 \text{ mm}$

Bolt size	Product designation	Ø_i [mm]	Ø_o [mm]	Thickness T [mm]	Chamfer C [mm]	Approx. weight kg/100 pairs	Min. Package [pairs]	
M12	SCM-12	13.1	23.7	4.6	1.2	1.0	100	
M16	5/8"	SCM-16	17.1	29.7	4.6	1.2	1.5	100
M20	SCM-20	21.4	36.7	4.6	1.5	2.3	100	
M22	7/8"	SCM-22	23.4	38.7	4.6	1.5	2.5	50
M24	SCM-24	25.3	43.7	4.6	1.5	3.2	50	
M27	SCM-27	28.4	49.5	5.8	1.8	5.6	25	
M30	1 1/8"	SCM-30	31.4	55.4	5.8	1.8	6.9	25
M36	1 3/8"	SCM-36	37.4	65.4	6.0	1.6	11.0	25

Material standard	Hardening	Coating	Corrosion resistance	Temperature range
Steel EN 1.7182	Through hardened	Delta Protok [®] KL100 zinc flake coating	Minimum 1,000 hours in salt spray test (according to ISO 9227)	-40°C to 150°C

- Torque guidelines:

Web app: torquelator.nord-lock.com
www.nord-lock.com/torque

-2D/3D CAD models:

www.nord-lock.com/cad

NEED A CUSTOM SOLUTION FOR A UNIQUE CHALLENGE?

Possible customization options:

- Coatings with improved corrosion resistance
- Colored coatings
- Custom inner and outer diameter
- Left-handed washers
- Custom thickness
- Custom materials
- Added chamfers
- Customer-unique laser marking

If you cannot find the washers you are looking for in our standard range, we will be happy to customize a solution for you.

Simply select your preferred dimensions, material and coating, and we will create the perfect washers for your application.

Contact Information :

Email : resh@mayuraengineering.com

Tel : 03 3322 3717

Fax. : 03 3322 3601

Website: www.mayuraengineering.com